

22/8010 Herdwick Pastures

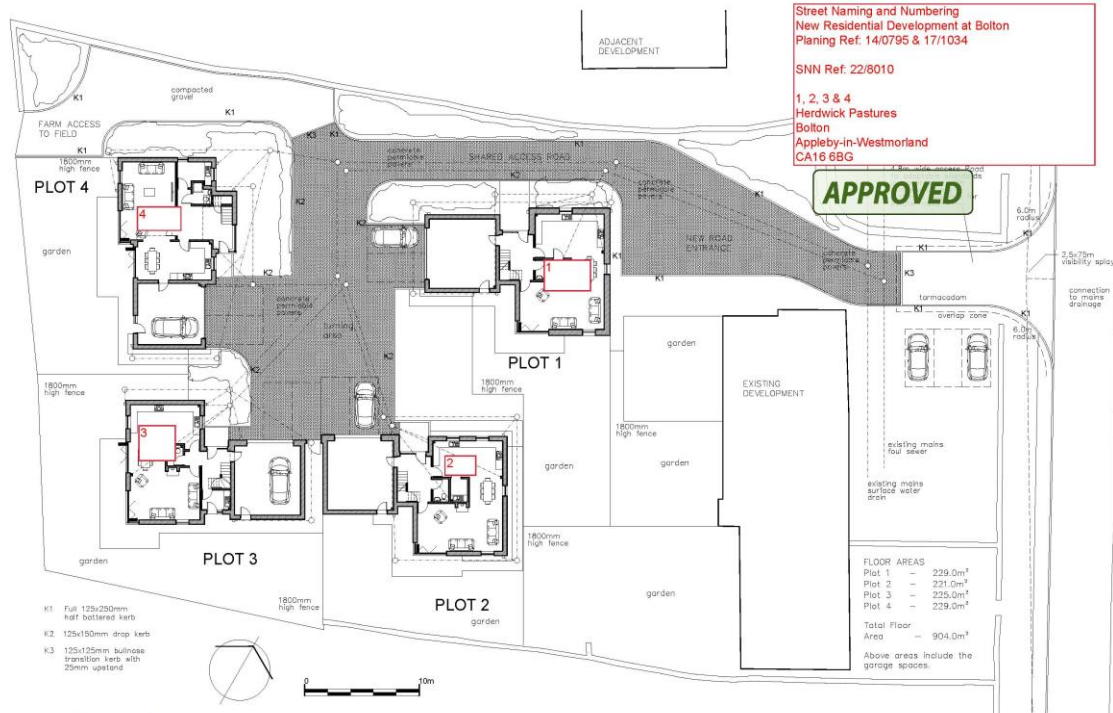

Street Naming and Numbering
 New Residential Development at Bolton
 Planning Ref: 14/0795 & 17/1034
 SNN Ref: 22/8010
 1, 2, 3 & 4
 Herdwick Pastures
 Bolton
 Appleby-in-Westmorland
 CA16 6BG

APPROVED

FLOOR AREAS

Plot 1	-	229.0m ²
Plot 2	-	221.0m ²
Plot 3	-	225.0m ²
Plot 4	-	229.0m ²
Total Floor Area	-	904.0m²

Above areas include the garage spaces.

LIVING
 building design
 Mark A Wilson Dip.Arch RIBA
 2 Gables Court, Millers Dale, Millers Dale, Bolton, Greater Manchester, M12 9JG
 Tel: 0161 275 4444 Fax: 0161 275 4445
 Email: mark@livingbuildingdesign.com Website: www.livingbuildingdesign.com

project:	Violet Bank Farm	
client:	Bolton Lodge Developments	
drawing title:	Site Layout	

revision:	date:	description:
A	29/11/17	Plots 2 and 3 amended.

date / details		drawing number	
date:	31/08/17	job no:	1704
scale:	1/250	stage:	B
paper:	A3	des no:	101
drawn:	ITW	rev:	A

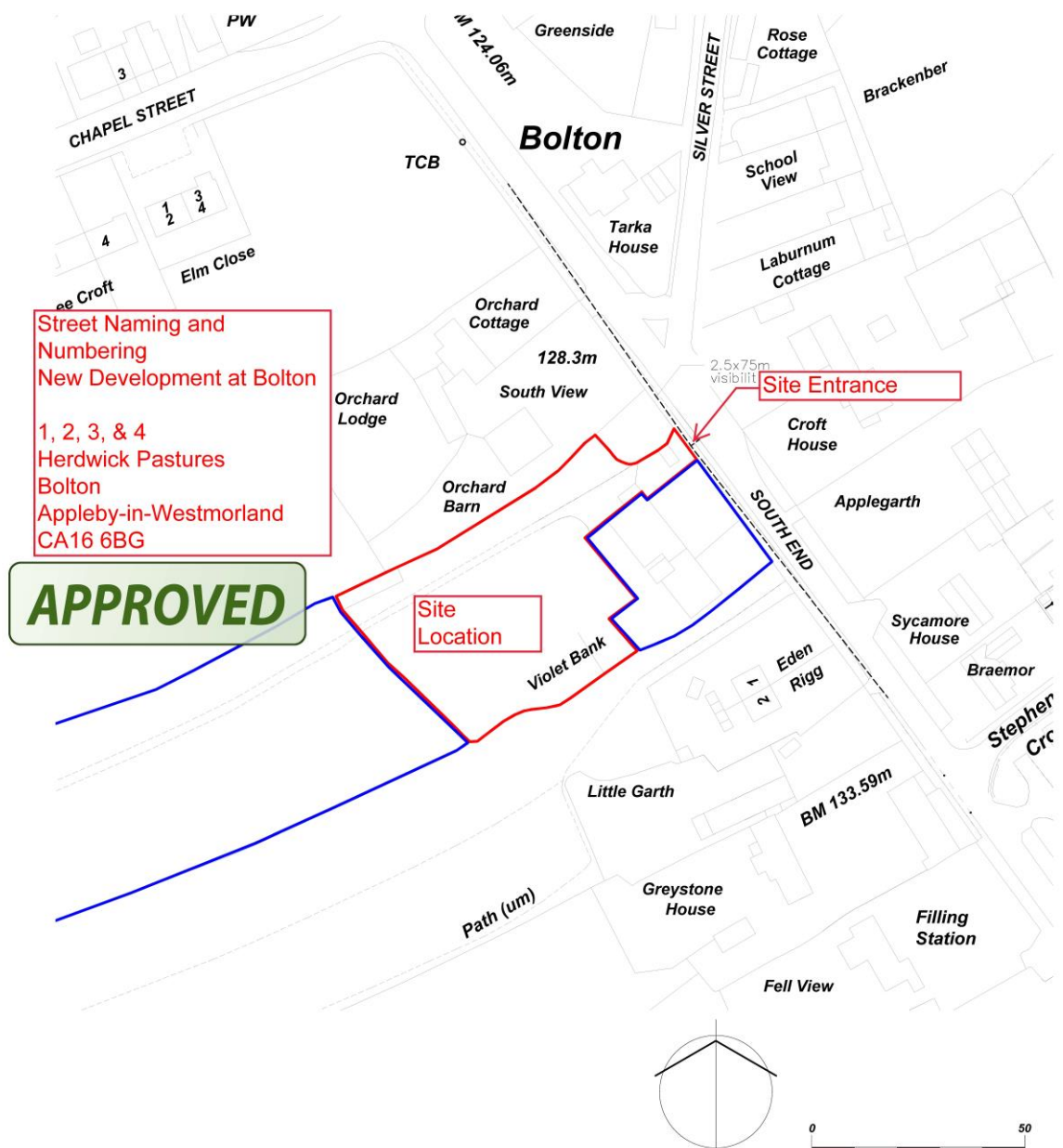

Street Naming and
Numbering
New Development at Bolton

1, 2, 3, & 4
Herdwick Pastures
Bolton
Appleby-in-Westmorland
CA16 6BG

APPROVED

revision:	date:	description:
-	-	-

date / details	
date:	06/11/17
scale:	1/1250
paper:	A4
drawn:	mw

drawing number	
job no:	1704
stage:	B
dwg no:	100
rev:	-

LIVING
building design

Mark A Wilson Dip.Arch RIBA
7 glebe court melsonby richmond north yorkshire DL10 5NU
telephone : 01325 718 293 mobile : 07908 745 659
email : living@melsonby.plus.com web : www.living-bd.co.uk

project:	Violet Bank Farm
client:	Bolton Lodge Developments
drawing title:	Location Plan