

APPROVED
By SNN at 9:59 am, Jun 21, 2017

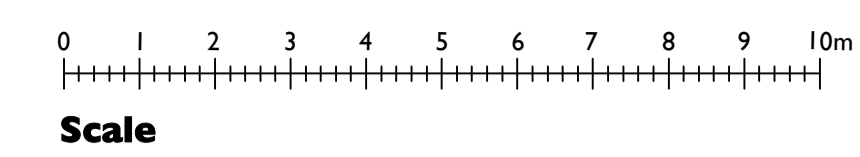

Client :	Eden Housing Association	Project No : 4485	Day Cummins Ltd Architects & Surveyors Lakeland Business Park Cockermouth Cumbria CA13 0QT Tel: 01900 820700 Fax: 01900 820701 www.day-cummins.co.uk
		Dwg No : 01	
Project :	Proposed Sheltered Housing Sim Court, Penrith	Date : 12/05/2016	
Drawing Title :	Location Plan	Scale : 1:1250	

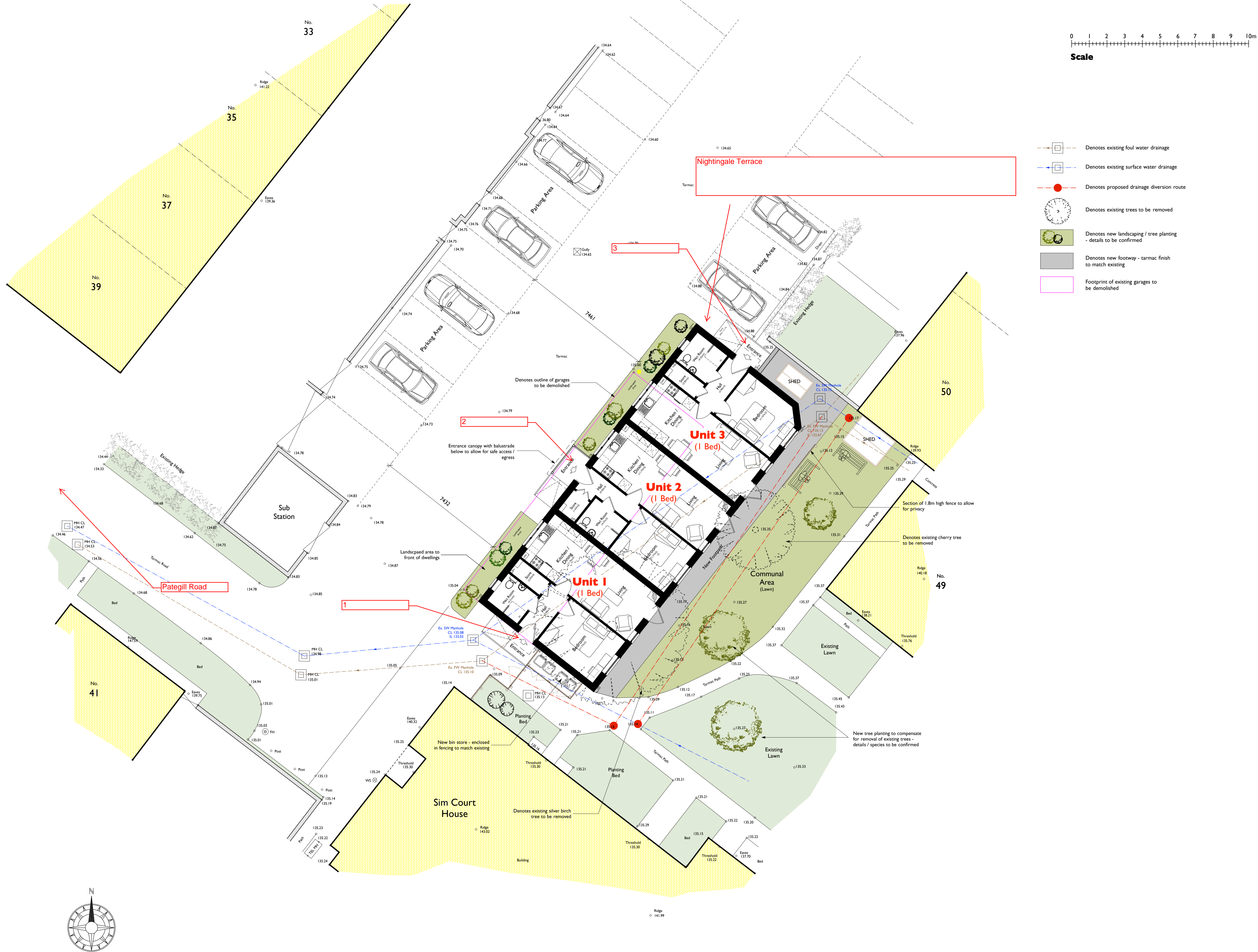

- Denotes existing foul water drainage
- Denotes existing surface water drainage
- Denotes proposed drainage diversion route
- Denotes existing trees to be removed
- Denotes new landscaping / tree planting - details to be confirmed
- Denotes new footway - tarmac finish to match existing
- Footprint of existing garages to be demolished

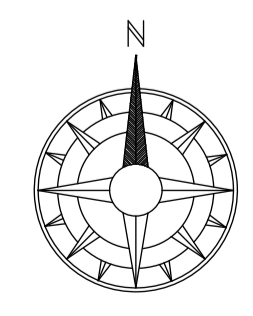

Rev:	Date:	Comments:	By:
Client:			
EDEN HOUSING ASSOCIATION			
DAY CUMMINS LIMITED Architects & Surveyors Lakeland Business Park Cockermouth Cumbria CA13 0QT Tel: 01900 820700 Fax: 01900 820701 email: dc@day-cummins.co.uk www.day-cummins.co.uk			
Project: Proposed Sheltered Housing Sim Court, Penrith			
Drawing Title: Existing Site Plan / Topo			
Drawn: MSJ	Checked: SEW	Signed:	
Scale: 1:100	Date: 04/07/16	Paper Size: A1	
ALL DIMENSIONS TO BE CHECKED ON SITE FIGURED DIMENSIONS TO BE TAKEN IN PREFERENCE TO SCALED DIMENSIONS THIS DRAWING IS COPYRIGHT			
Project No: 4485	Drawing No: 02	Rev: -	